

# RESIDENCE E

## 2 BEDROOMS, 2-1/2 BATHS

2,003 sq. ft. 186.18m  
264 sq. ft. 24.53m balcony

2,267 sq. ft. 210.71m total

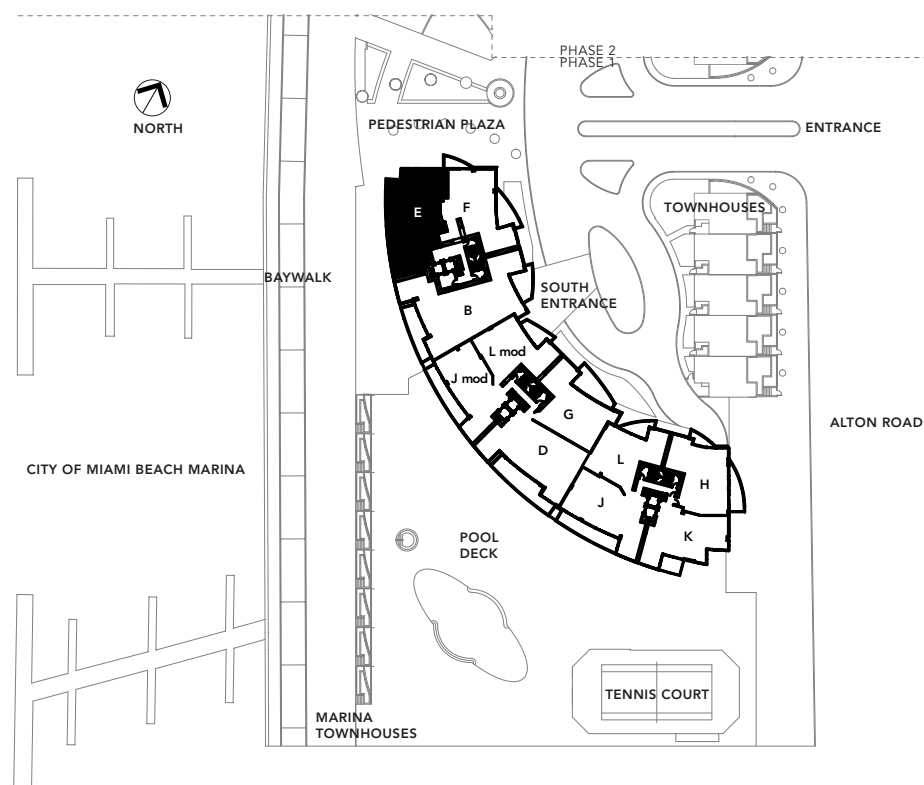

**Zilbert REALTY GROUP**

Contact:  
**Mark Zilbert**  
Web: [www.zilbert.com](http://www.zilbert.com)  
Tel: (786) 280-0201  
E-Mail: [mzilbert@zilbert.com](mailto:mzilbert@zilbert.com)

Zilbert Realty Group is an independent broker, not affiliated with the developer

**MURANO GRANDE**  
AT PORTOFINO